

Fast Set Postfix

Product guide

Fast Set Postfix is a simple to use fast-setting concrete mix for fixing posts in the ground. It requires no pre-mixing before use. It contains Portland Cement and special additives together with sharp sand and aggregate (nominal size of gravel is 10mm).

Application

Fence posts, gate posts, pergolas,
garden lighting and rotary lines.

Instructions for use

01. Position post in hole.
02. Add two litres of water.
03. Empty the complete bag into hole around the post.
04. Check the position of the post and adjust as necessary.
05. Tamp to remove any air bubbles.
06. If necessary, sprinkle more water to mix any remaining powder left on the surface.

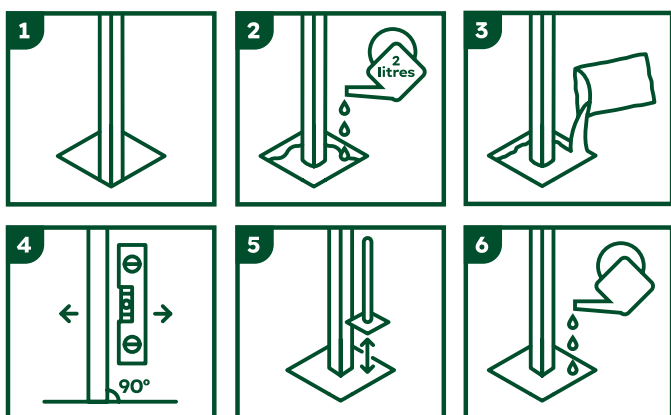

Allow around 5 minutes for initial set to take place – following this, the post will remain in a vertical position unsupported. Fast Set Postfix will achieve appreciable strength after 2-4 hours depending on ambient conditions but is best left overnight before attaching fence panels etc.

