

Old Ingleton Quarry

Site Biodiversity Action Plan



Site Information- Old Ingleton

Site Name and Location	Old Ingleton quarry located is located 2km to the north-east of Ingleton, North Yorkshire, on the western edge of the North Pennine moors Grid Ref – SD719753
Hanson Company	Hanson Aggregates - North
BAP(s) that will be targeted	UK BAP Harrogate LBAP
Habitat(s) to be developed	Calcareous grassland
BAP species to be encouraged	<i>Birds:</i> Peregrine <i>Amphibians:</i> Great Crested Newt (potential for breeding waders)
Designated Natural Area	Yorkshire Dales
Background and site description	The quarry is inactive having been last worked in the 1970s and lies adjacent to the active Ingleton Quarry. It comprises areas of poor and developing grassland, bare ground and shallow pools in the quarry and an area of calcareous grassland and mire within the older part of the quarry. Large sites of high botanical and geological interest surround the site.
National Designations (SSSI, SAC, SPAs, RAMSARs and NPs) within 500m	Ingleborough SSSI Wherside SSSI Ingleborough Complex SAC. Seato Pastures SSSI Thornton and Twistleton Glens SSSI.
Resource Requirements	Restoration budget.
Contribution to biodiversity	Calcareous grassland conservation and management is both a national and local BAP target. Upland breeding bird species are national and local BAP targets.
Partners and Local initiatives	Potential for sourcing hay from Ingleborough National Nature Reserve
Other documents supporting the site BAP	Restoration Plan Old Ingleton Management Plan (2004) Old Ingleton Quarry Restoration Plan (2006)

Site Layout

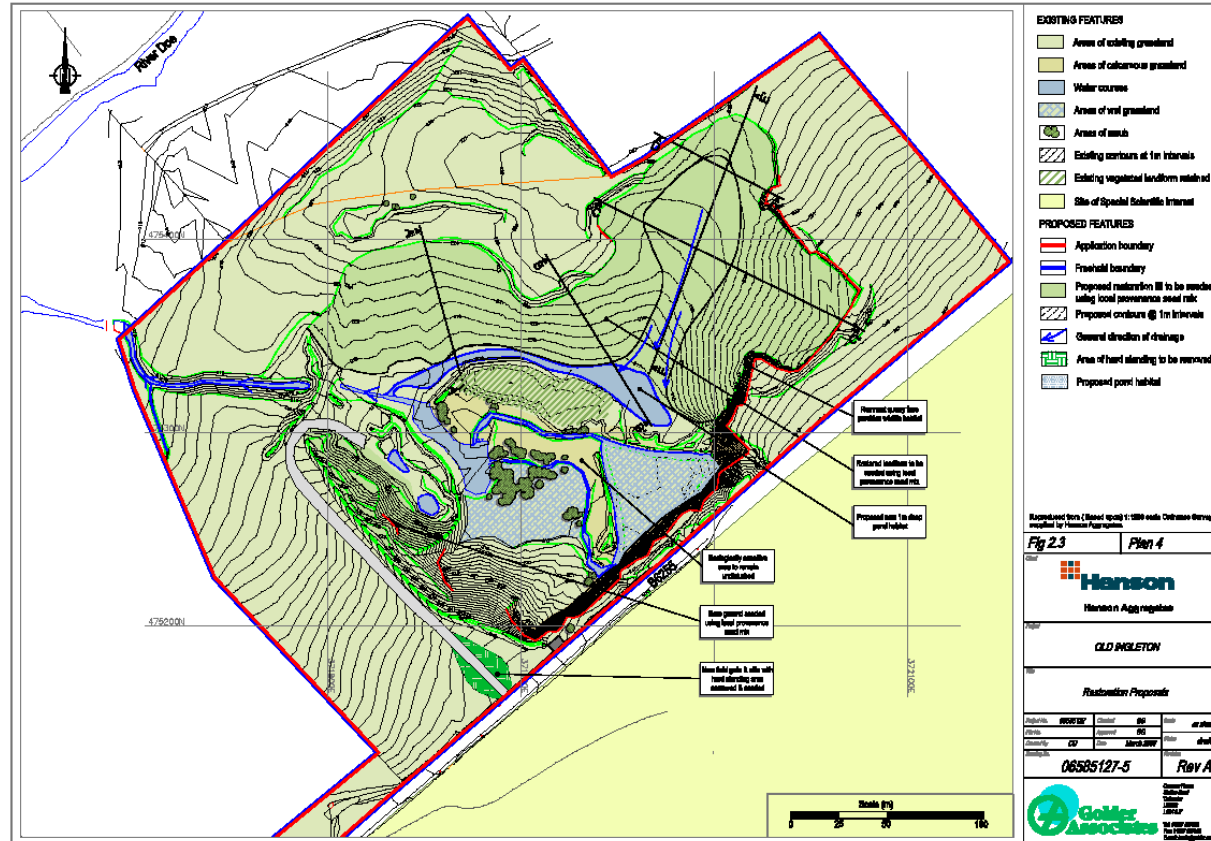

Action Plan

Item No.	Objective	Biodiversity Feature	Targets	Tasks	Assessing Indicator	Responsible Person	Timescale (Completion)
1	Habitat restoration and aftercare of restored quarry area and spoil heaps	Calcareous grassland	Restore 2ha of upland calcareous grassland close to original contours with spoil from Ingleton (subject to approval)	1.Manage quarry infill and contour to agreed plan 2.Permit natural revegetation	Walk over survey after 2014 – bi-annual Annual report	Landscape Architect Consultant Ecologist	Restoration Completed 2014
2	Habitat management of naturally revegetated quarry floor	Conservation of calcareous and marshy grassland and scrub	Maintain 2ha of calcareous and marshy grassland	1.Broadcast of harvested wildflower and grass seed 2.Maintain stock fencing	Walk over survey after 2014 bi-annual Annual report	Landscape Architect	2014
3	Species conservation and management	Breeding peregrine Upland breeding birds Notable flora	Safeguard breeding peregrine (and raven) on cliffs Manage grassland with appropriate grazing to promote breeding waders	1.Locate and protect existing known peregrine nests and limit disturbance on site by making site staff aware 2.Investigate Peregrine watching scheme. 3. Organise sheep grazing when sward established	Site Manager to inform site staff and contractors working close to nest sites. Annual report	Landscape Architect Site manager	Ongoing until 2036
4	Habitat and species monitoring	Maintain agreed monitoring programme. Encourage local staff and public involvement where possible via local specialist groups	Ensure target habitats and species are monitored and appropriate response agreed as per management plan Bird monitoring data collected by staff, external volunteers and ecological consultants and summarised in annual report.	Annual walkover and surveys as agreed with YDNP	Monitoring reports	Landscape Architect Consultant Ecologist	2014 to 2036

5	Communications and publicity	Produce communications materials that explain importance of Ingleton biodiversity including 'flagship' species	Produce display board for Ingleton All local schools regard and use site as educational resource	Draft display, agree artwork and design and produce to highlight key habitat and species conservation work Coordinate Ingleton School visit with Old Ingleton for demonstration of restoration and the importance of biodiversity. Consider display board and nature trail creation to tie in with GAP activities	Display on site No of colleges, universities, schools and students visiting site	Landscape Architect Site manager	2015
---	------------------------------	--	---	---	---	-------------------------------------	------