

## Bozeat

# Site Biodiversity Action Plan



### Site Information- Bozeat

|   |  |
|---|--|
| <b>Site Name and Location (incl. Grid Ref.)</b>                             | Bozeat Quarry, Northamptonshire (SP8995597)  |
| <b>Hanson Company</b>   | HANSON AGGREGATES – CENTRAL  |
| <b>BAP(s) that will be targeted</b>   | National BAP<br>Northant's BAP   |
| <b>Habitat(s) to be developed</b>   | Hedgerows, Farmland Margins, ponds and Broadleaved Woodland  |
| <b>BAP species to be encouraged</b>   | Great Crested Newt<br>Badger   |
| <b>Designated Natural Area</b>  | Yardley-Whittlewood Ridge and N'hants Vales  |
| <b>Background and site description</b>                                      | Bozeat is a 31 hectare sand and gravel quarry complex, working a deposit of the Quaternary fluvio-glacial sand and gravels and Boulderclay. The site is being restored to recreate an area of Farmland enclosed by hedgerows and semi-natural broadleaved woodland with ponds. |
| <b>National Designations (SSSI, SAC, SPAs, RAMSARs and NPs) within 500m</b> | SSSI- Bozeat Meadow Ref: 1002715<br><a href="http://www.sssi.naturalengland.org.uk/special/sssi/sssi_details.cfm?sssi_id=1001277">http://www.sssi.naturalengland.org.uk/special/sssi/sssi_details.cfm?sssi_id=1001277</a>  |
| <b>Resource Requirements-comment on cost if appropriate</b>                 | Pre-stripping ecological surveys and protected species monitoring reports, which are planning and legislative requirements.<br>Protection of existing habitat features& GCN pop'n.<br>Creation of woodland and ponds.  |
| <b>Contribution to biodiversity</b>   | Woodland and Farmland with hedgerows and ponds.local and national BAP habitat targets.<br>The restoration of the site will augment an existing conservation value and will create a significant wildlife resource in the area.   |
| <b>Partners and Local initiatives</b>                                       | N'hants Wildlife Trust.  |
| <b>Other documents supporting the site BAP</b>                              | Bozeat Quarries Environmental Statement<br>Protected species reports (confidential).   |

# Site Layout

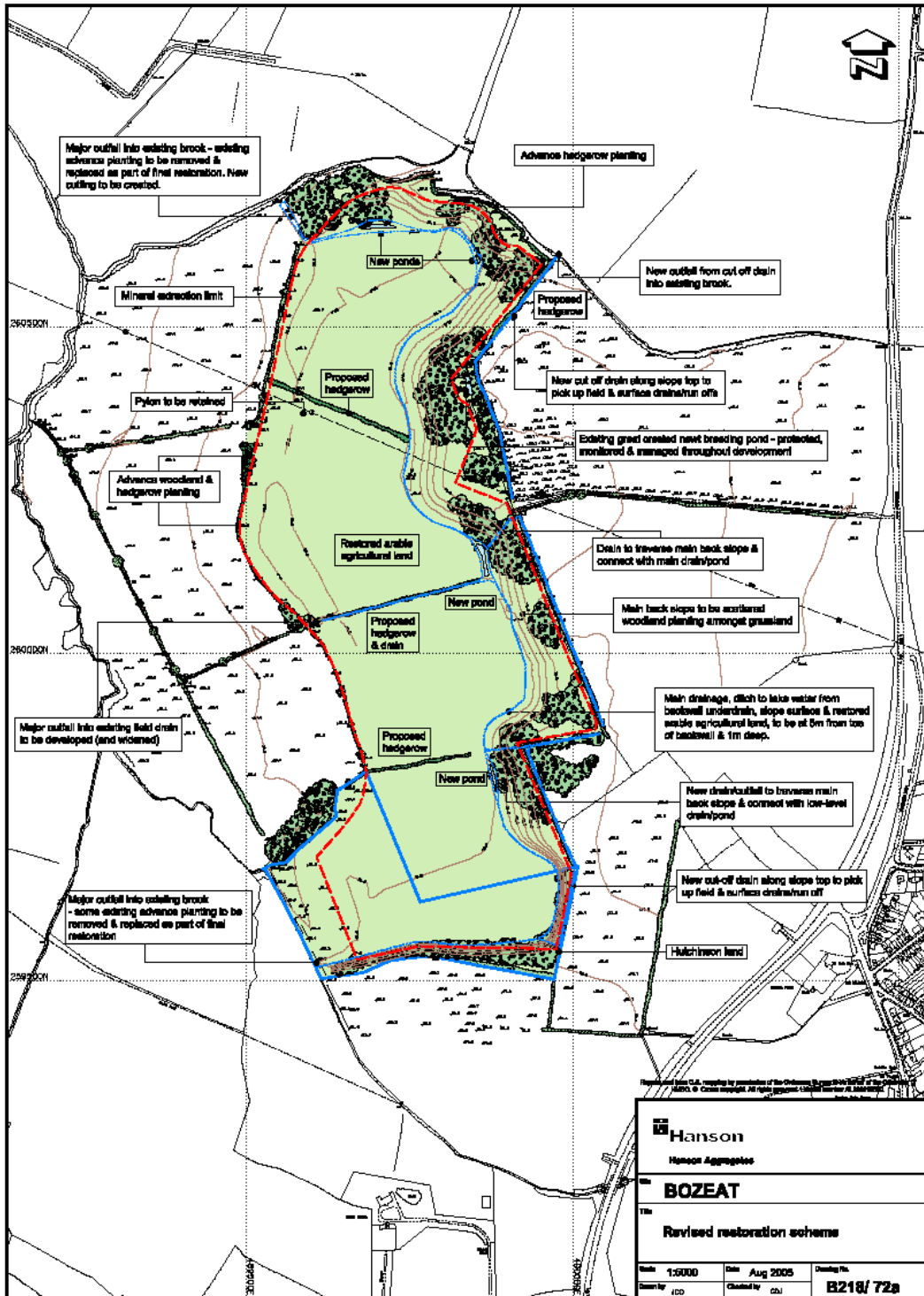

## Action Plan

| Item No. | Objective                   | Biodiversity Feature                         | Targets   | Tasks   | Assessing Indicator   | Responsible Person                    | Timescale (Completion)  |
|----------|-----------------------------|--|---|---|---|---------------------------------------|---|
| 1        | Restore important habitats. | Farmland and hedgerows with ponds .          | Create 30 ha of Farmland  | In compliance with proposed restoration scheme.   | Land area restored (ha).  | Landscape Architect.                  | Annual aftercare report for life of site (6 years).               |
|          |                             | Broadleaved woodland and scrub with ponding. | Create 4 hectares of broadleaved woodland (including open areas and glades).  | Restore to extensive areas of broadleaf woodland with open areas (approx 20% area) allowing natural regeneration and increasing biodiversity potential. Woodland establishment will be by planting of native tree and shrub species to compliment the woodland in the surrounding area. | Area of woodland planted (ha).  | Landscape Architect.                  | Report on woodland planting as it occurs throughout life of site. |
| 2        | Protect species.            | GC. Newt, Badger, Sand Martin.               | Minimise disturbance to existing site populations. Monitor protected species at least once every two years at. Tin Pits SINC. | Protect existing known nests/habitats and limit disturbance on site by making site staff aware of habitat areas. Monitor site for development of new nests/habitats   | Bi-annual species monitoring reports. Site Manager and Landscape architect to inform site staff and contractors working close to habitat areas. | Landscape Architect.<br>Site Manager. | Every two years for life of site.                                 |