

Ripon Quarry

Site Biodiversity Action Plan



Site Information - Ripon

Site Name and Location	Ripon Quarry, North Stainley, near Ripon Grid Ref – SE297773
Hanson Company	Hanson Aggregates - North
BAP(s) that will be targeted	UK BAP Harrogate BAP
Habitat(s) to be developed	Reed-bed Lowland Meadows Woodland Flowing Water Standing Water Arable Farmland
BAP species to be encouraged	<i>Mammals:</i> Otter, Water Vole <i>Birds:</i> Bittern, Reed bunting <i>Invertebrates:</i> Freshwater white-clawed crayfish <i>Higher plants:</i> Thistle broomrape <i>Other notable species:</i> Little ringed plover, Lesser spotted woodpecker*, Marsh tit*, Willow tit*, River lamprey, Yellow star-of- Bethlehem *Red listed species
Designated Natural Area	Pennine Dales Fringe.
Background and site description	The quarry is located on the floodplain of the River Ure with the river and adjacent grasslands and woodlands. Ripon Quarry covers two areas either side of the river. Extensive biological recording is conducted by a local conservation group and ecology group. The management aims are to return the fringe sections of the north site to productive agriculture and to restore and manage the core area to create high value biodiversity habitats including open water; reed-bed and wet woodland. The Pennycrofts site to the south will be restored to wet woodland, open water and fringing reed and march habitat.
National Designations (SSSI, SAC, SPAs, RAMSARs and NPs) within 500m	The quarry is located on the floodplain of the River Ure adjacent to Ripon Parks SSSI. The SSSI comprises a range of habitats associated with the river and adjacent grasslands and woodlands. Three SINC's, all woodlands, are also adjacent to the site.
Resource Requirements-	Restoration budget.
Contribution to biodiversity	Ripon Quarry, when fully worked and subsequently restored, has the potential to hold national BAP priority habitats and species most notably reed-bed, wet woodland, marsh, open mosaic and hedgerows. The wetland habitats have the potential to be of SSSI quality and a popular location for quiet recreation including watching wildlife and angling.
Partners and Local initiatives	Ripon Quarry Conservation Advisory Group Bellflask Ecological Survey Team High Batts conservation volunteers
Other documents supporting the site BAP	Management Plan Bellflask Ecological Survey Team reports High Batts 'In at the Start' reports

Site Layouts

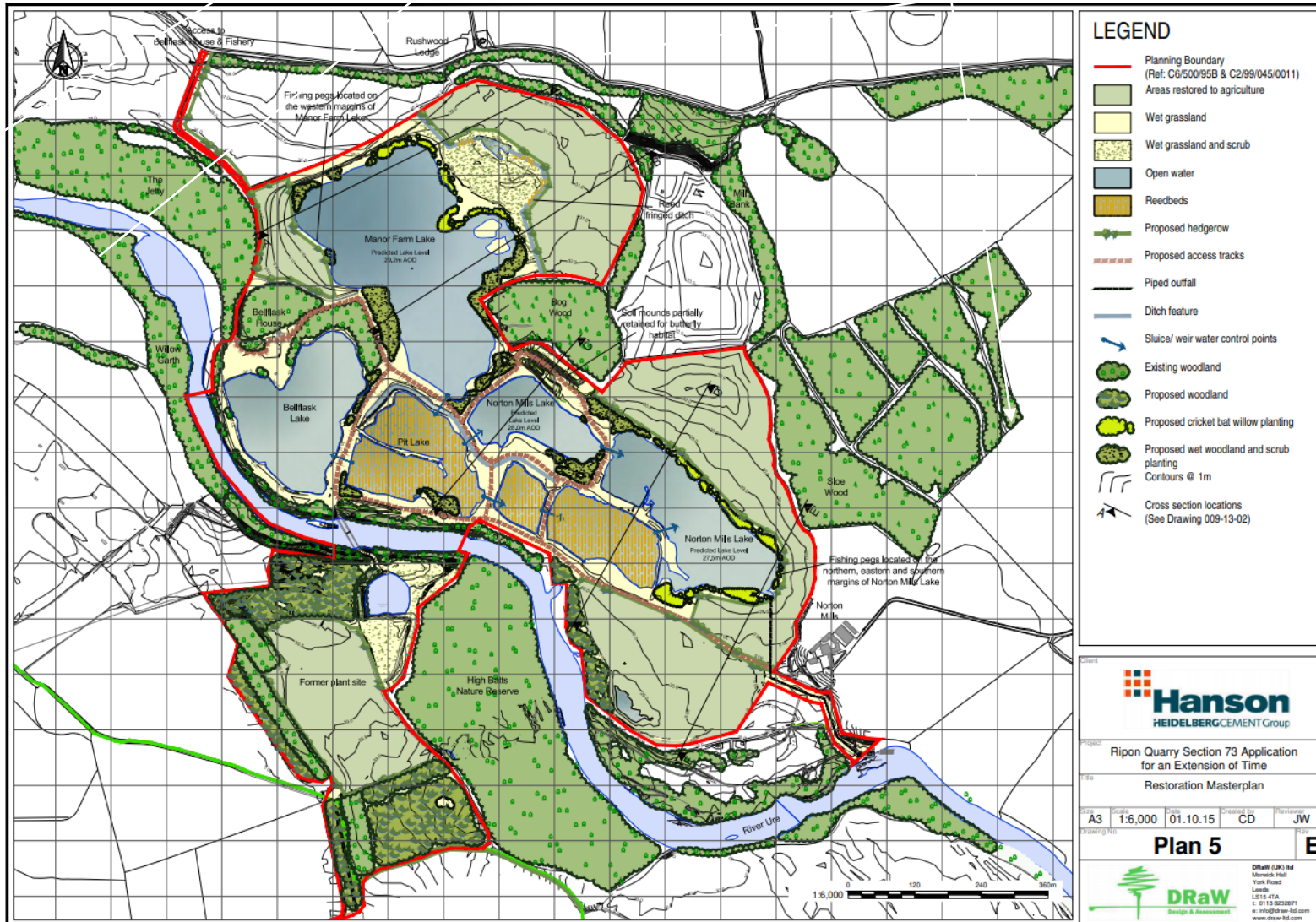

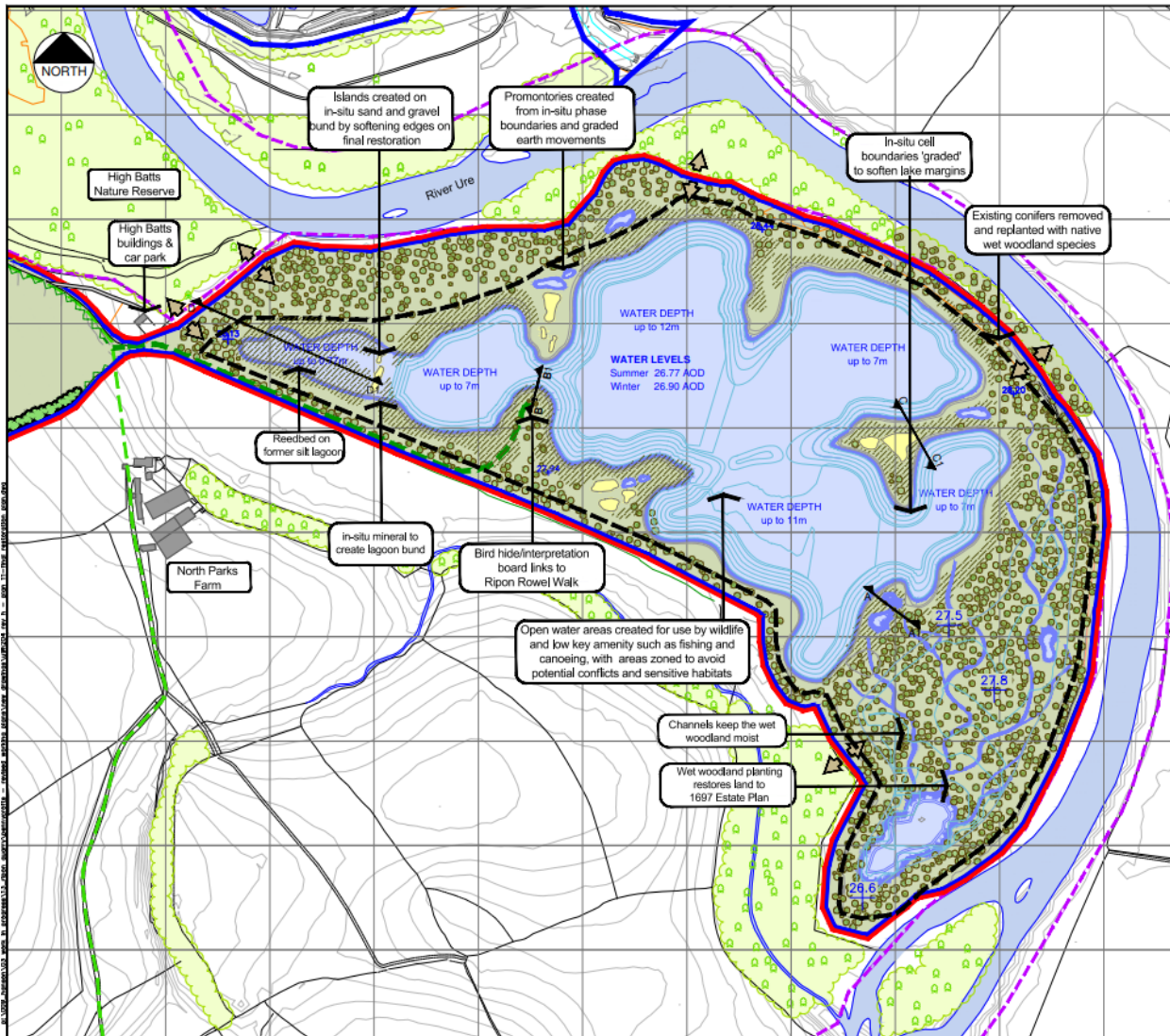

LEGEND

Existing Features

- Planning permission boundary
- Land in applicant's control
- SSSI boundary
- Ripon Rowel Walk - Bridleway
- Buildings
- Mature Woodland
- Agricultural field

Proposed Features

- Planning application boundary
- Open water/channels
- Reedswamp margins
- Shallow ponds
- Wet woodland
- Hedgerow planting
- Bare ground /shingle Islands
- Habitat linkages
- Permissive footpath link to bird hide from the Ripon Rowel Walk
- Indicative spot levels
- Cross Section location

Plan No.11/Fig 2.10
 Reproduced by permission of Ordnance Survey on behalf of HMSO. © Crown copyright and database right 2009. All rights reserved. Ordnance Survey licence number 0100032140.



Site: **RIPON EXTENSION**
 Title: **Final Restoration Plan**

Scale: 1:3500	Paper Size: A3	Drawn by: CD	Drawing No.:	Revision:
Date: Sept 2016	Check by: JI	U9h/204	H	

Action Plan

Item No.	Objective	Biodiversity Feature	Targets	Tasks	Assessing Indicator	Responsible Person	Timescale (Completion)
1	To restore agricultural land with wildlife friendly margins	<ul style="list-style-type: none"> Arable agriculture with wildlife buffer strips. 	<ol style="list-style-type: none"> 29ha of agri. land. Wildlife buffer strips along hedgerows. 	<ol style="list-style-type: none"> Restore agricultural land Create buffer strips adjacent to hedgerow planting 	<ol style="list-style-type: none"> Land area restored/managed (ha). Buffer strips created/managed (m). Annual Report 	Landscape Architect.	Ongoing until 2027/ end of aftercare on the northern site.
2	To create and manage areas of open water	Open water: <ul style="list-style-type: none"> Bellflask Lake Manor Farm Lake Norton Mills Lake Pit Lake Pennycrofts 	<ol style="list-style-type: none"> Maintain disturbance-free zones for waterfowl and other species. Manage fishery by restricting pitches to Manor Farm only adjacent to agricultural land. 	<ol style="list-style-type: none"> Bird counts. Appropriate signage. Regular liaison with angling club. 	<ol style="list-style-type: none"> Waterfowl counts. Fishery management. Annual Report. 	Landscape Architect. Ecologist. BEST	Ongoing until 2042
3	To create and manage reed-beds and wetland habitats	<ul style="list-style-type: none"> Phragmites australis reedbeds in 4 cells. Small areas of inundation grassland at lake margins. 	<ol style="list-style-type: none"> 10ha of phragmites australis reed-bed habitat. Ongoing planting and maintenance of existing reed beds. 	<ol style="list-style-type: none"> Plant and maintain reeds. 	<ol style="list-style-type: none"> Area planted and expanded (Ha) Monitoring as detailed in the management plan for the site. Marginal habitats around open water bodies (m). Annual Report. 	Landscape Architect. Ecological Consultants.	Ongoing until 2042
4	To create and manage woodlands and hedgerows.	<ul style="list-style-type: none"> Broad leaved woodland Wet woodland Hedgerows 	<ol style="list-style-type: none"> Maintain original woodland area pre-quarrying. Establish and manage woodland along NW edge of Norton Mills Lake to mitigate loss of Bog Wood. Create wet woodland, in particular at Pennycrofts. Ensure connectivity between woodlands by creating hedgerows and 	<ol style="list-style-type: none"> Woodland and hedgerow planting programme including fencing. Manage hedgerow development by cutting or laying. 	<ol style="list-style-type: none"> Land area managed (ha). Area of trees planted and maintained (ha). Hedgerow planted and maintained (m). Annual Report. 	Site Manager. Landscape Architect.	Ongoing until 2042

			shelterbelts.				
5	To encourage conserve and manage species on site.	<ul style="list-style-type: none"> • Bittern • Reed bunting • Otter • Water vole • Thistle broomrape • Little ringed Plover and other nesting birds 	<ol style="list-style-type: none"> 1. Manage wetlands to create optimal bittern habitat (water levels, eel and fish prey) 2. Manage human disturbance to sensitive habitats (reed beds, ditches, wet woodland and inundation grasslands). 	<ol style="list-style-type: none"> 1. Protect existing known nests/habitats. 2. Limit disturbance on site by making site staff aware of habitat areas. 	<ol style="list-style-type: none"> 1. No of species on site. 2. Annual Report. 	Site Manager. Landscape Architect. Ecologist.	Ongoing until 2042
6	To monitor habitats & species appearing on site.	As above.	<ol style="list-style-type: none"> 1. Ensure target species are monitored and appropriate response agreed. 2. Monitoring data on bird and rare plant species collected by High Batts and BEST and summarised in annual report. 	<ol style="list-style-type: none"> 1.Undertake bird counts and Breeding Bird Surveys 2.Monitor all target fish, invertebrate and plant populations for 5 years (2022-2027) north of river 	<ol style="list-style-type: none"> 1. Monitoring reports 2. Monitoring reports in local specialist publications. 3. Annual Report. 	Site Manager. Ecological Consultants.	Ongoing until 2027 and 2042
7	To communicate and publicise interesting features on site (where appropriate)	As above.	1. Produce a display board at Pennycrofts.	1. Produce display board for use on site.	1.Display boards on site.	Landscape Architect. Site Manager.	Ongoing until 2042